



DOUGLAS COLLEGE

CAMPUS GUIDE

COQUITLAM CAMPUS 2021-2022

douglascollege.ca

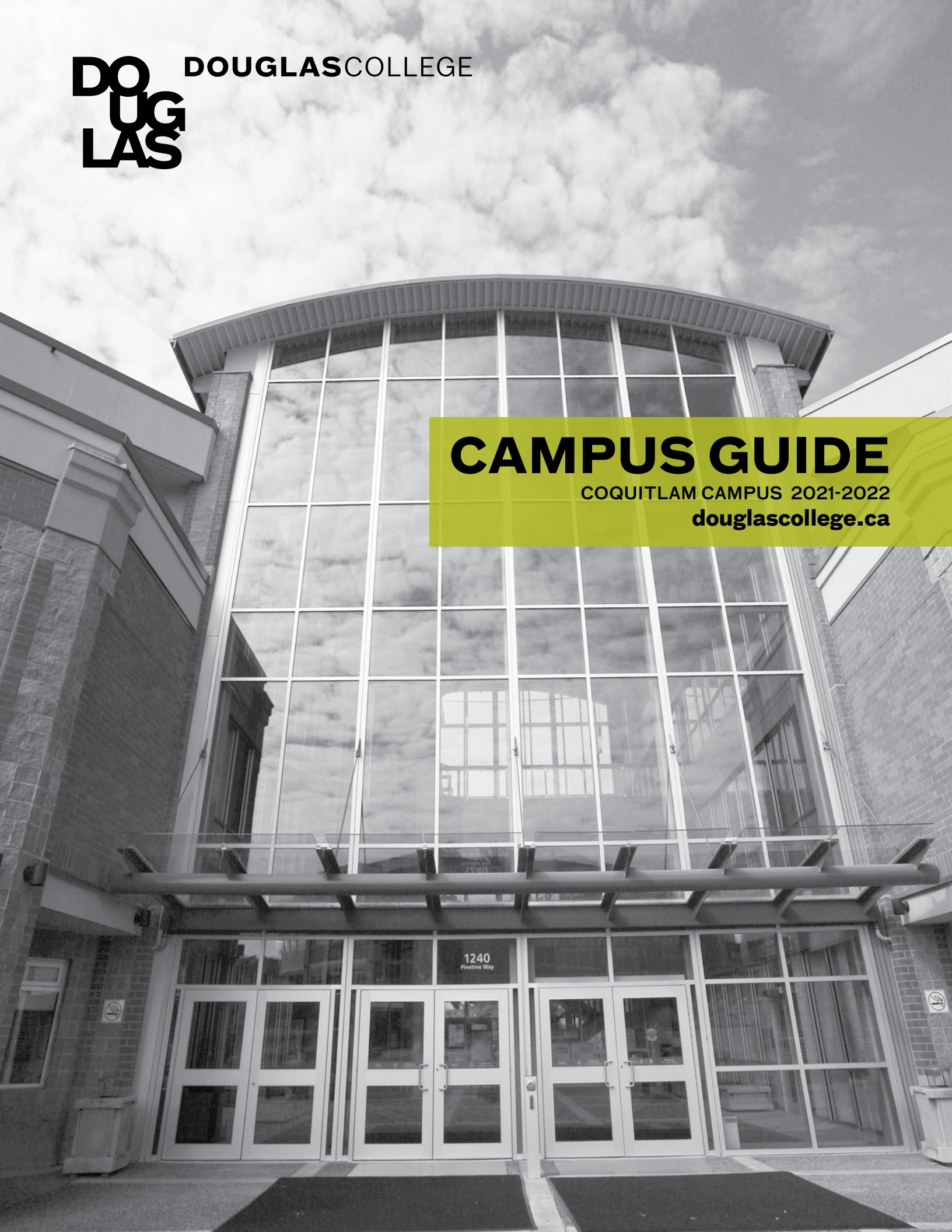



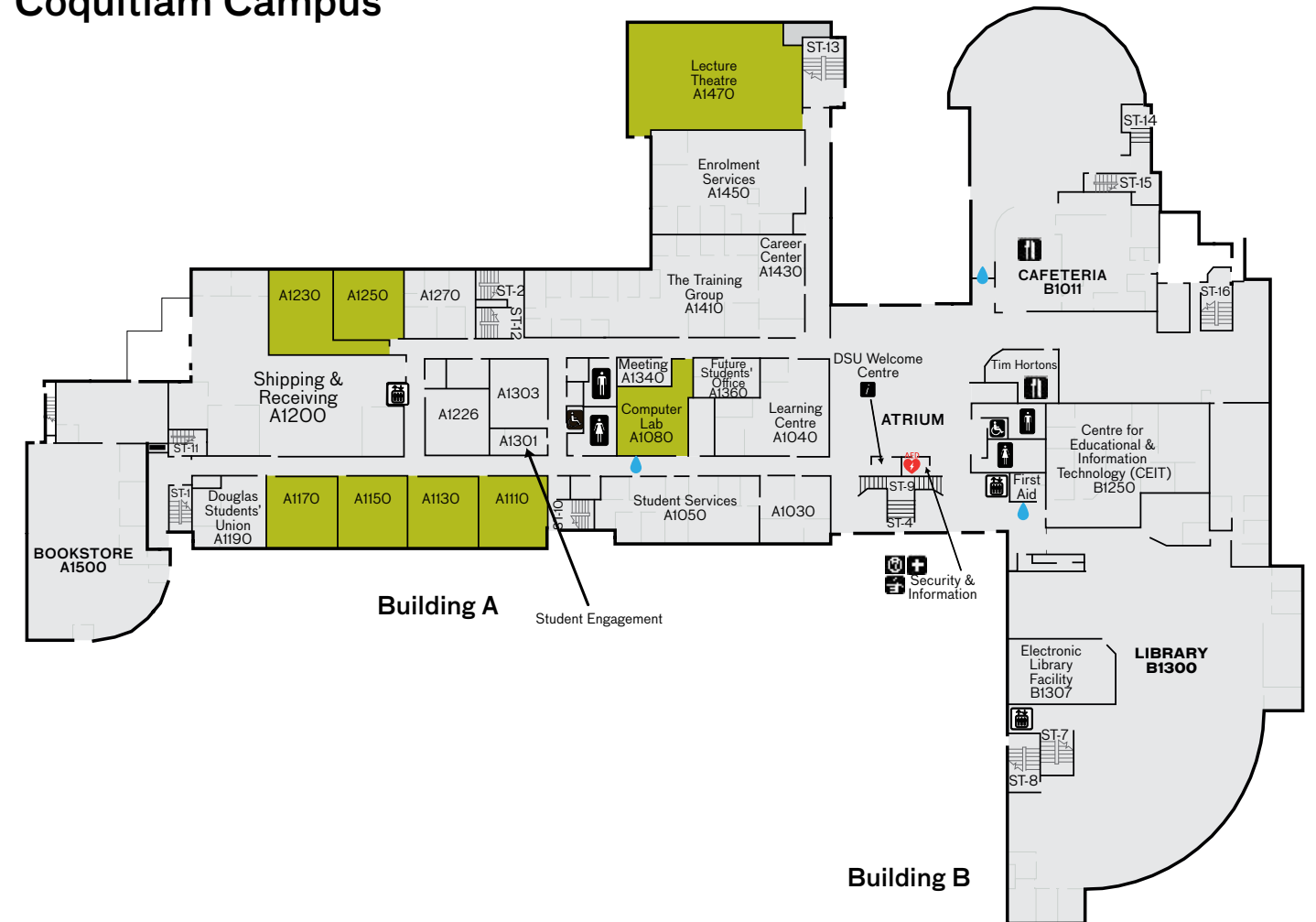

First Floor - Building A & B Coquitlam Campus





LEVEL 1

A1040	Learning Centre	B1011	Cafeteria
A1050	Student Services	B1250	Centre for Educational & Information Technology (CEIT)
	• Counselling	B1300	Library
	• Accessibility Services	B1307	Electronic Library Facility
A1080	Computer Lab		Water Fill Station
A1190	Douglas Students' Union		AED Location
A1200	Shipping & Receiving		
A1301	Student Engagement		
A1301A	International Education		
A1360	Future Students' Office		
A1410	The Training Group		
A1430	Career Centre		
A1450	Enrolment Services		
A1470	Lecture Theatre		
A1500	Bookstore		

Second Floor - Building A & B Coquitlam Campus





LEVEL 2

A2030	Computer Lab	B2002	Faculty of Language, Literature & Performing Arts
A2040	Dispensing Opticianry	B2100	Video Conferencing Room
A2081	Therapeutic Recreation Lab	B2190	Language Lab
A2095	Math Lab	B2210 & B2230	Geography Lab
A2100	Physics & Geology Lab	B2270	Psychology Lab
A2110&30	Computer Lab		Water Fill Station
A2143&45	Veterinary Technology (VTEC) Lab		AED Location
A2163	Biology Lab		
A2190	Chemistry		
A2270	Computer Lab		
A2280&90	Hospitality Management Classroom & Lab		

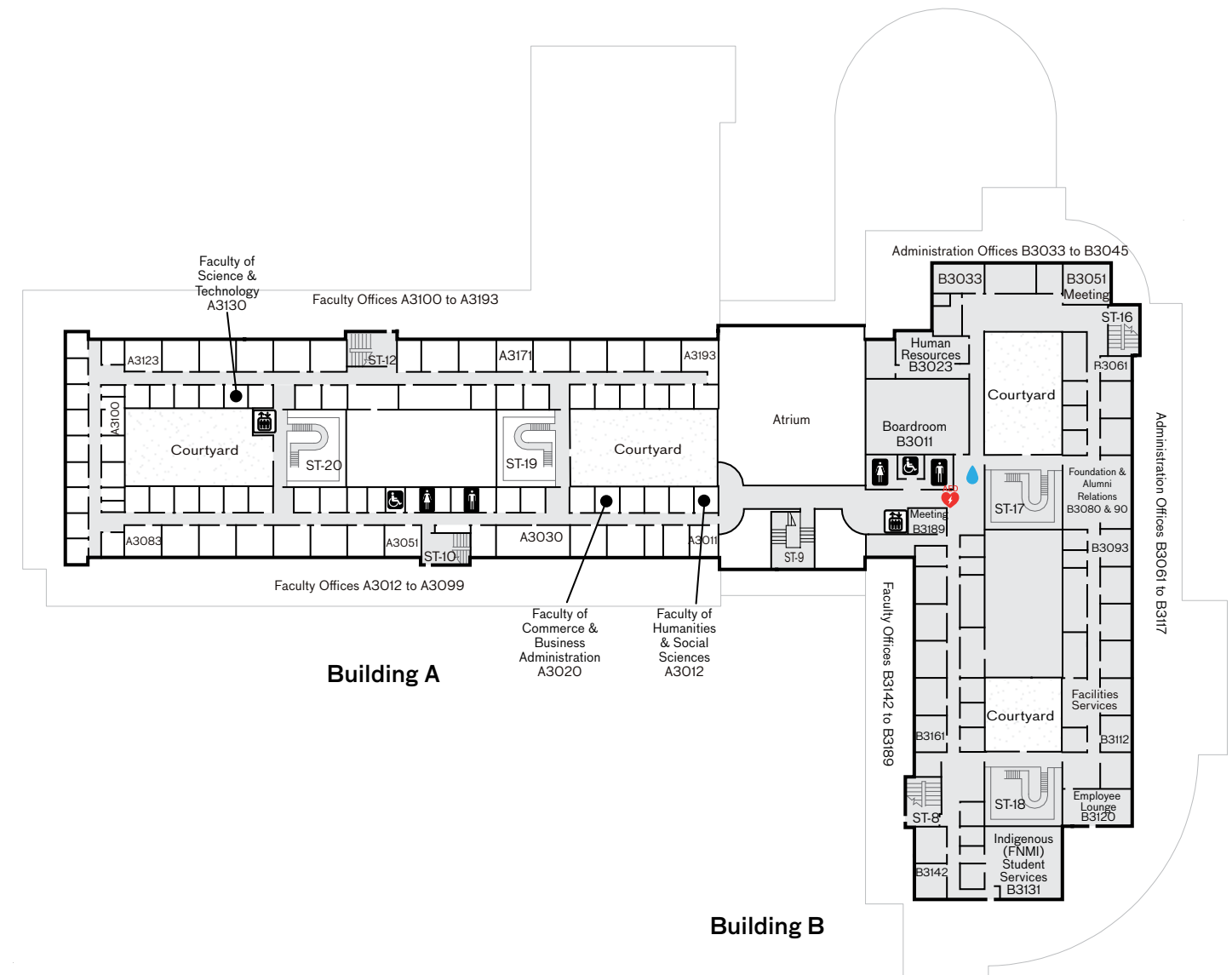
Third Floor - Building A & B Coquitlam Campus



LEVEL 3

A3012	Faculty of Humanities & Social Sciences	B3080&90	Foundation and Alumni Relations
A3020	Faculty of Commerce & Business Administration	B3112	Facilities Services
A3130	Faculty of Science & Technology	B3120	Employee Lounge
B3011	Boardroom	B3131	Indigenous (FNMI) Student Services
B3023	Human Resources		Water Fill Station
			AED Location

First Floor - Building C & D Coquitlam Campus



LEVEL 1

D1040&C1020 Faculty of Applied Community Studies
 Water Fill Station
 AED Location

Second Floor - Building C & D Coquitlam Campus



LEVEL 2

C2009&2050 Faculty of Health Sciences Labs
 D2005 CEIT
 D2010 Health Information Management Lab
 D2012 Computer Lab

D2016&17 Communications Lab
 Water Fill Station
 AED Location

Third Floor - Building C & D Coquitlam Campus

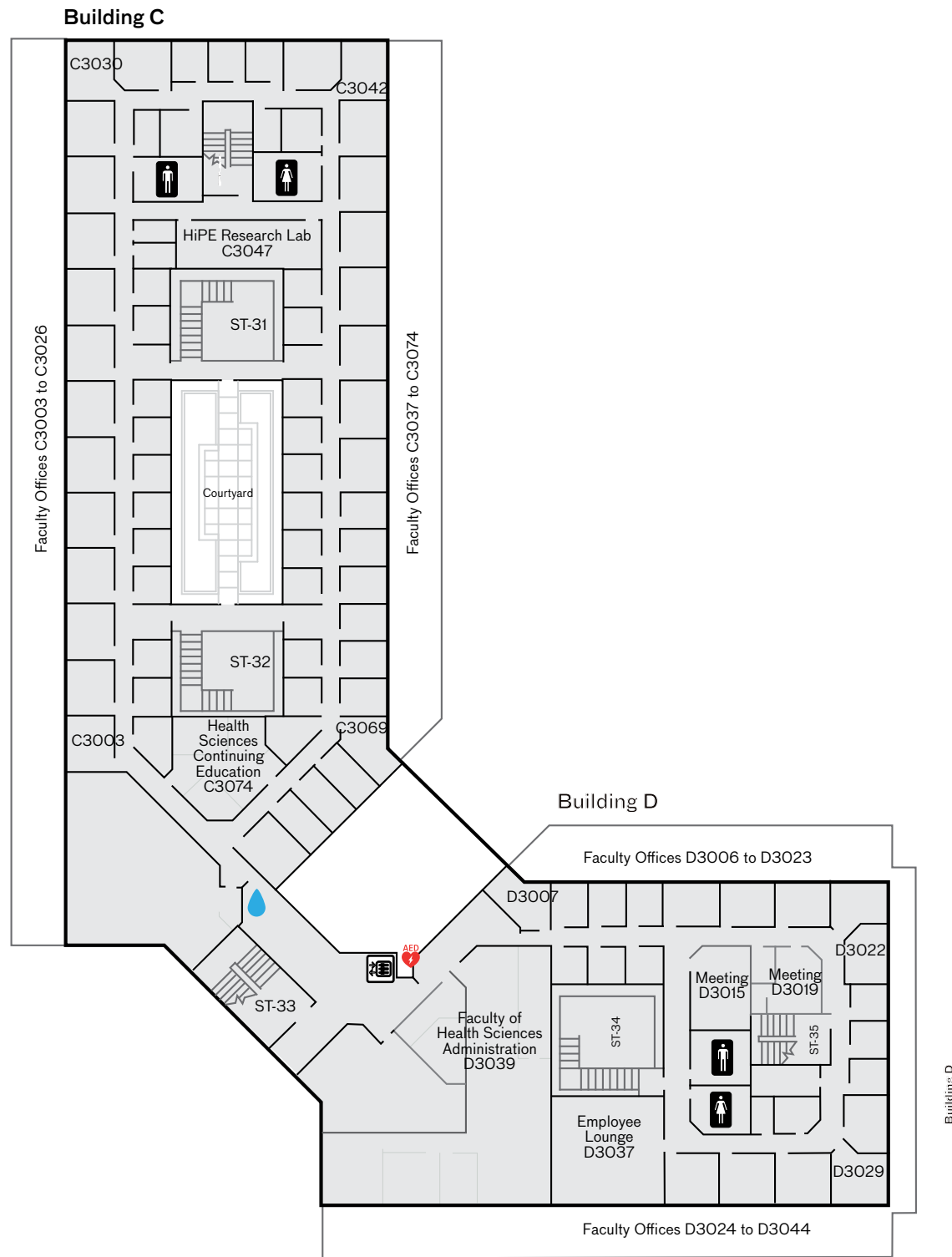

LEVEL 3

- c3047 HiPE Research Lab
- c3074 Faculty of Health Sciences - Continuing Education
- d3037 Employee Lounge
- d3039 Faculty of Health Sciences Administration
-  Water Fill Station
-  AED Location

Exterior Building and Parking Map Coquitlam Campus

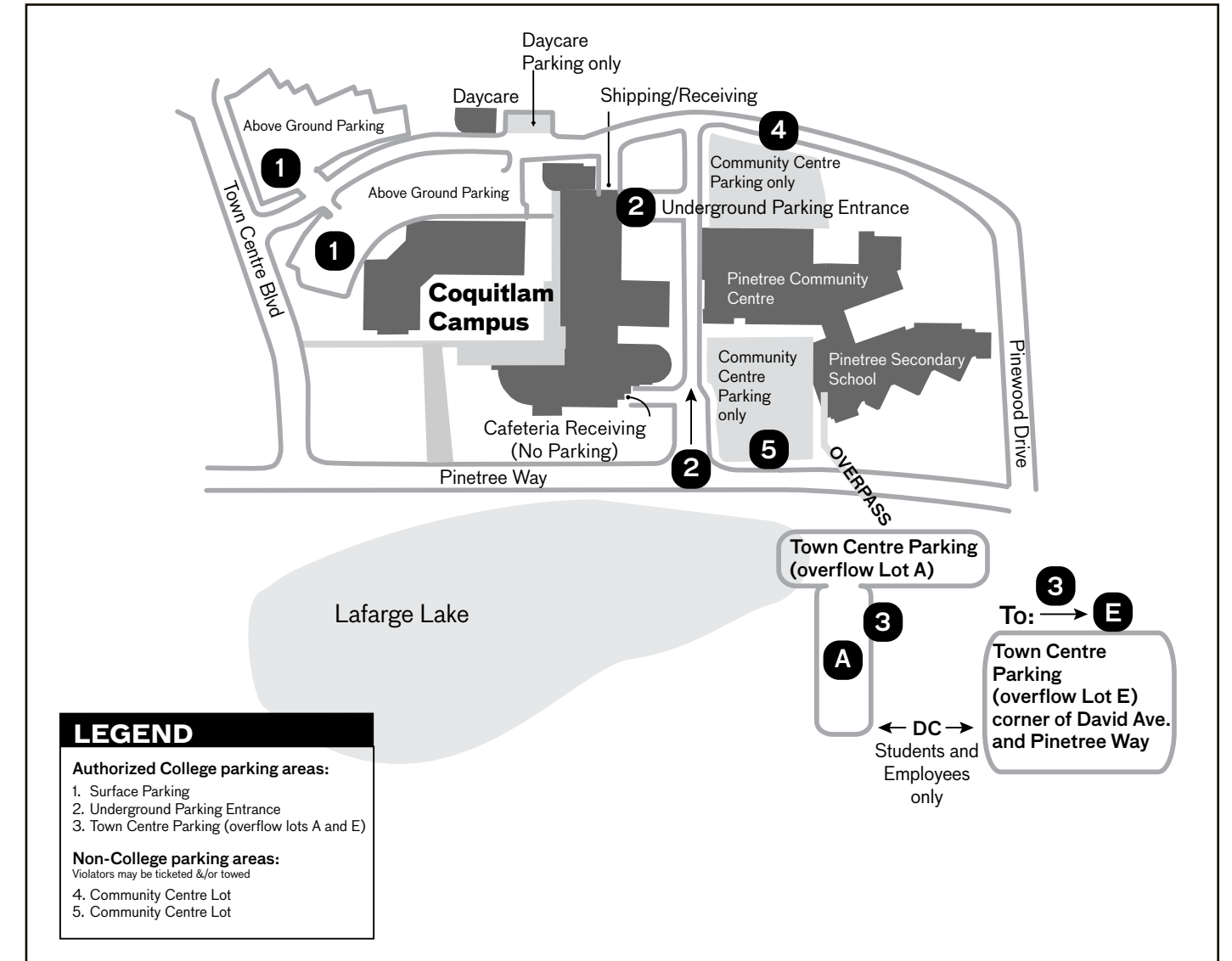

Note: Lots 1 and A and E: Student permit parking. Lot 2: Employee and hourly parking

CAMPUS STREET ADDRESS

1250 Pinetree Way, Coquitlam, B.C. V3B 7X3

MAILING ADDRESS (FOR ALL CAMPUSES)

PO Box 2503, New Westminster, B.C. V3L 5B2

CENTRAL SWITCHBOARD

604 527 5400

CAMPUS HOURS

Monday to Friday 6:30am-11pm
Saturday 6:30am-11pm
Sunday & Holidays Closed (limited access*)

* Access at Building A/B. Valid and current College ID must be shown to security.

ACCESS FOR VISITORS OR STUDENTS WITH ACCESSIBILITY NEEDS

Reserved parking for people with accessibility needs is available in the above ground and underground parking lots.

INFORMATION

Inquiries should be made at Security in the Atrium of Building A/B (main floor).

ROOM NUMBERS

The campus is divided into two buildings: Building A/B and Building C/D. Room numbers are prefixed by the building letter and floor level. Classrooms are labelled in green on these maps.

FOOD SERVICE

Meals and snacks are available in the Cafeteria located on the northeast side of the Building A/B Atrium (main floor) and coffee and snacks are available at the kiosk of Building C/D (main floor).

SMOKE-FREE CAMPUS

Douglas College is a smoke-free campus. The policy prohibits smoking, vaping and chewing tobacco on all Douglas College Campuses and sites including parkades.

SECURITY

Call 2400 from internal College telephones for all emergencies: fire/police/ambulance and first aid. Security and First Aid is located in the Atrium (main floor level) of Building A/B.

Security can be contacted at:

Non-emergency: 604 777 6255 or 604 307 4537 (cell).





DOUGLAS COLLEGE